



# InGranite Recon Ltd.

Reconstituted Stone | Modern Material | Classic Style

UK info@ingranite.co.uk  
www.ingranite.co.uk

ROI info@ingranite.ie  
www.ingranite.ie

0808 2349118

057 9331462

## Technical specification sheet

Title: Rathgar window surround

Date: 21/02/2017

Ref: Rathgar

Scale: 1:10

Drawn by: InGranite

Approximate weight:

38kgs/meter

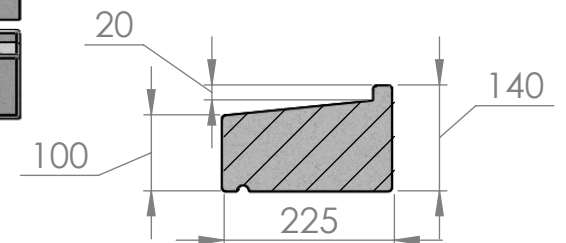
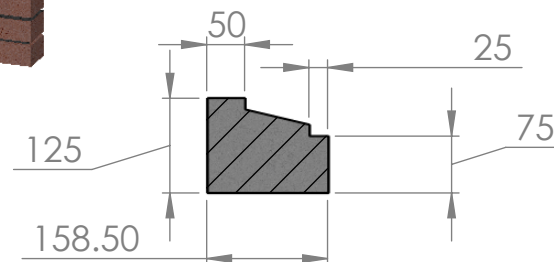
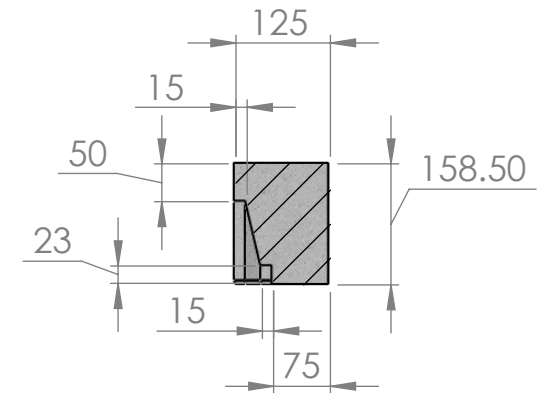
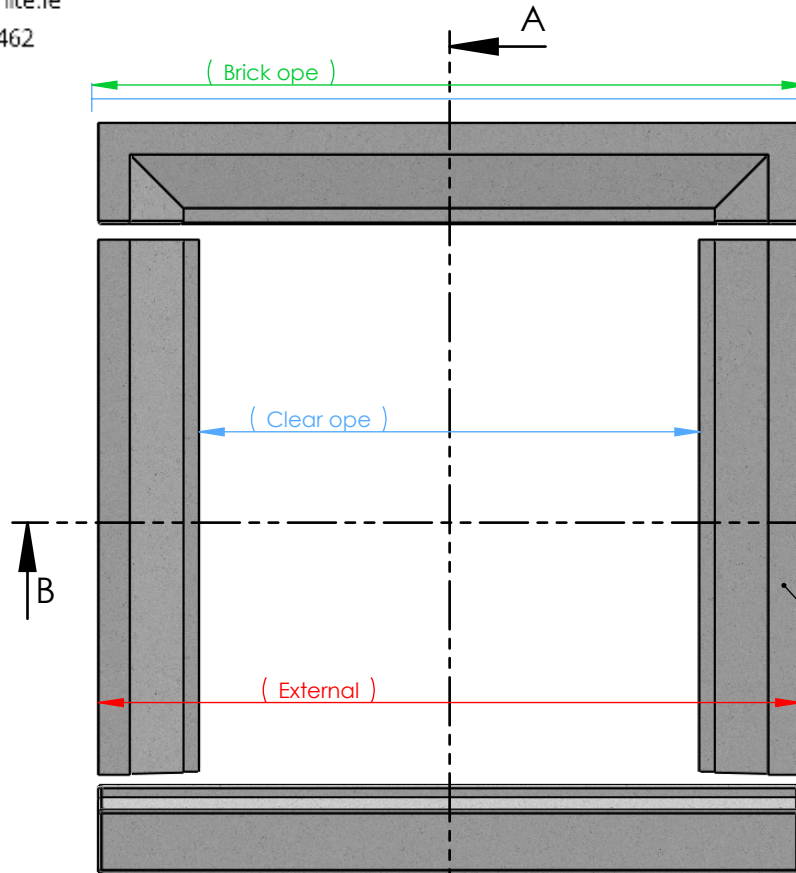
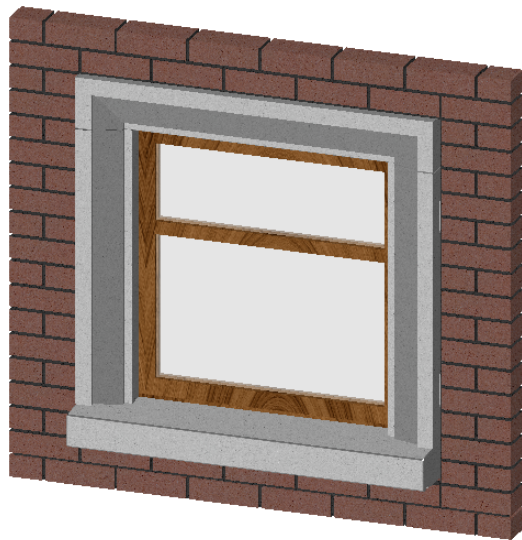

SECTION B-B  
SCALE 1 : 10

SECTION A-A  
SCALE 1 : 10

All dimensions are in millimetres. For non listed sizes please contact InGranite Recon LTD.

All units manufactured to brick dimensions

All vertical faces typically have a 4mm taper per 100mm of height.

The information contained in this drawing was correct at the time of going to print. Profiles, sizes and weights are given as indication only.