

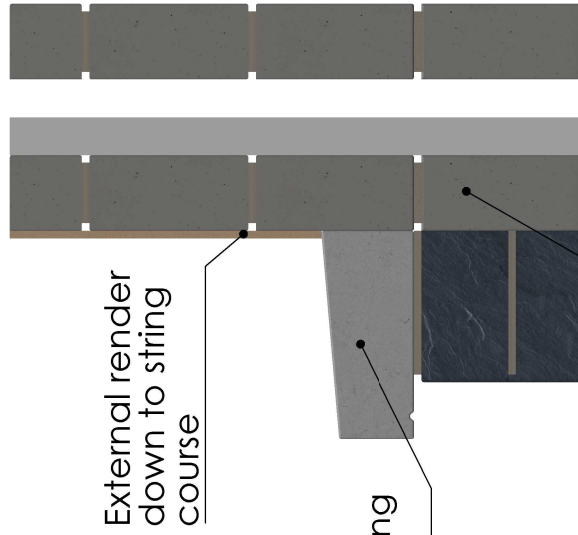

**InGranite Recon Ltd.**  
 Reconstituted Stone | Modern Material | Classic Style  
 UK info@ingranite.co.uk Rol info@ingranite.ie  
 www.ingranite.co.uk www.ingranite.ie  
 0808 2349118 057 9331462

**Technical specification sheet**

Title: Masonbrook string course 2	
Date: 16/11/2017	Ref: MSB/275/SC
Scale: 1:10	Drawn by: InGranite
Approximate weight: 63kgs	

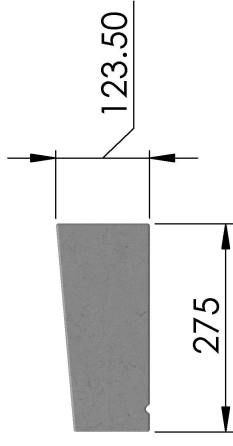
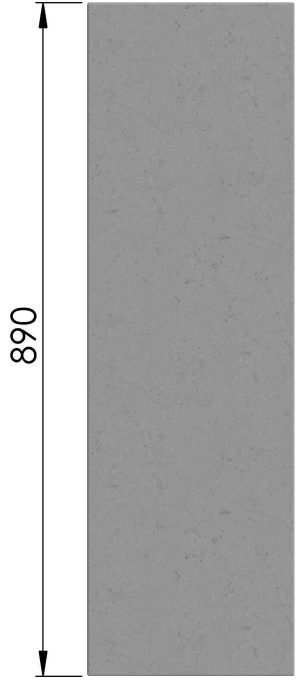

External render down to string course

275 wide string course

External blockwork

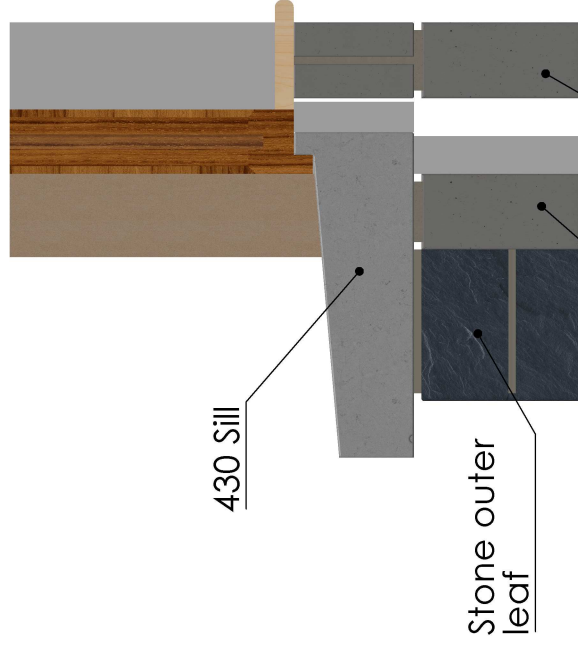

430 Sill

Stone outer leaf

External blockwork

Internal blockwork

All dimensions are in millimetres. For non listed sizes please contact InGranite Recon LTD.

All vertical faces typically have a 4mm taper per 100mm of height. The information contained in this drawing was correct at the time of going to print. Profiles, sizes and weights are given as indication only.